

OPTIONAL:

Self-tapping screws (#7) and holes on the Mounting Plate (#1) are offered as a permanent mounting option. Please consult your grill manufacturer before installation, as it may void your grill warranty. The Grease Box LLC disclaims any responsibility for grill damage. The self-mounting option is entirely at your own risk, and by using self-tapping screws, you voluntarily assume all associated risks. The Grease Box LLC shall not be liable for any damage resulting from this self-mounting option.

THE GREASE BOX LLC
Questions or comments?
THEGREASEBOX.COM > Contact Us

THE GREASE BOX

PATENT PENDING



THEGREASEBOX.COM

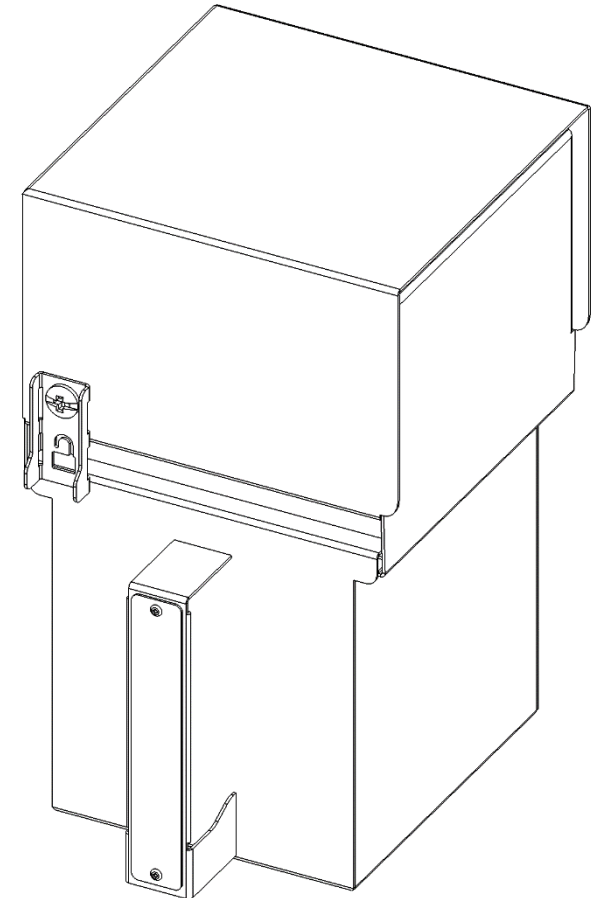

WARNING: ATTACHING THIS PRODUCT MAY VOID THE WARRANTY TO YOUR OUTDOOR COOKING APPARATUS. THE GREASE BOX LLC IS NOT LIABLE FOR FAULTY INSTALLATIONS, IMPROPER MAINTENANCE, OR ANY ISSUES RELATED TO THE COOKING APPARATUS.

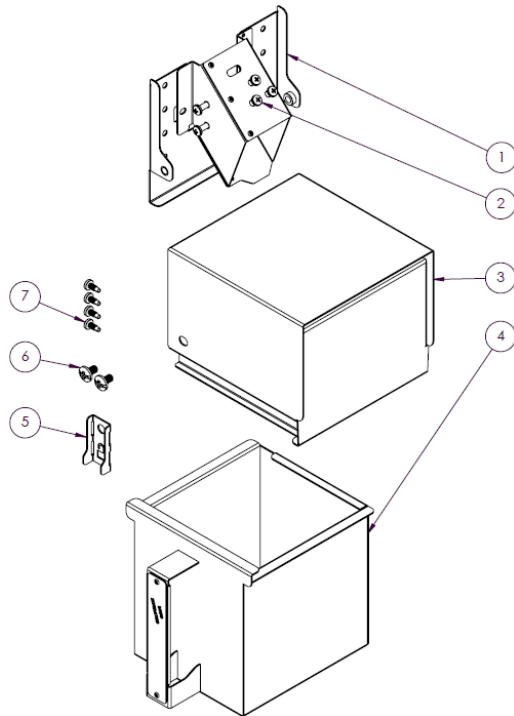
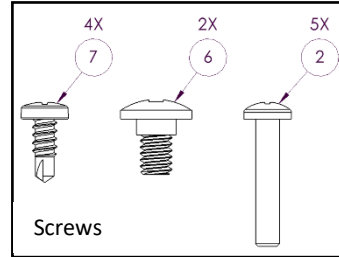
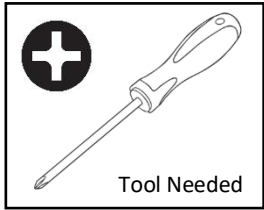

1. Mounting Plate
2. Mounting Screws
3. Top Cover
4. Sliding Drawer
5. Lock
6. Shoulder Screws
7. OPTIONAL Self-Tapping Screws [if needed, see last page]

STEP 1: PREPARATION

- Go to THEGREASEBOX.COM to confirm compatibility to your grill before proceeding with the installation.
- Make sure grill is turned off and cooled.
- On your grill, clean entire grease spout with non-abrasive cloth, including 4 inches in each direction on the flat vertical surface. This will ensure Mounting Plate (#1) can be properly mounted tight to grill. Cleaning can be accomplished with soap and water.

VIDEO INSTALLATION GUIDE:

Find the video installation guide by going to THEGREASEBOX.COM, or by scanning this QR code.



STEP 2: INSTALLATION

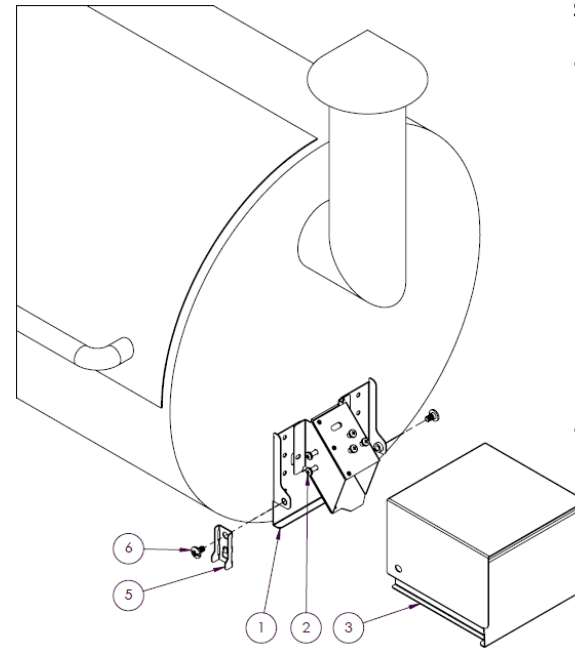

- Place Mounting Plate (#1) around grill spout as shown, applying upward pressure to hold it tight to grill. Using a screwdriver, tighten all Mounting Screws (#2) to make a firm connection with the grill. *If your grill has a spout that this method of mounting will not work on, then refer to back page of this document.*

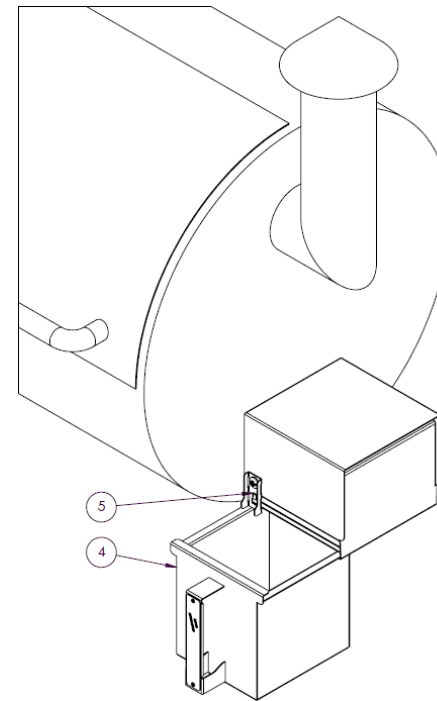

- Hang Top Cover (#3) on Mounting Plate (#1) by aligning the center of them, pushing the Top Cover back tight to the grill and lower it down until it hooks onto the Mounting Plate. If done correctly, it will be level and semi-locked into position.
- Fully lock it into position using both Shoulder Screws (#6) and attach the Lock (#5) nearest the front side of the grill. The Lock should dangle and be able to be rotated upward setting against the side of the grill to remain out of the way for sliding the drawer in.
- Take the Sliding Drawer (#4) and install it as shown, with the handle towards the front of the grill. Push it all the way back and rotate the lock down. *Optional: Install Sliding Drawer with the handle and Lock towards the back of the grill if preferred.*
- At this point The Grease Box is fully installed, locked, and ready for its first cook. *It's recommended to empty grease contents after every use.*